

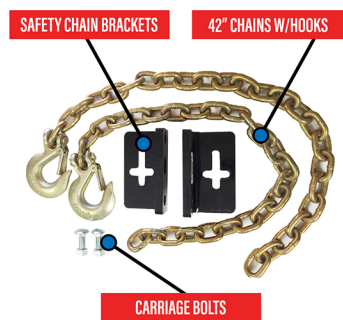

QUICKAIR - 5TH TO GOOSE/ SAFETY CHAIN KIT SETUP INSTRUCTIONS

PATENT #'s: 11,370,257 B1 & D898,628

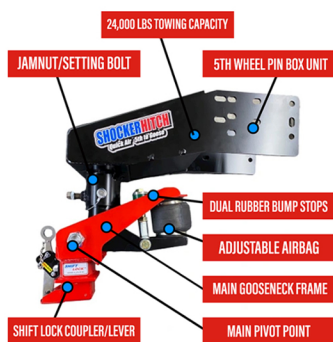

SAFETY CHAINS SOLD SEPERATELY

QUICKAIR PIN BOX INSTALLATION

-Unbolt your existing 5th wheel pin box from your camper/trailer and any brake cables. With assistance, remove your 5th wheel pin box and set it aside and/or put it away in storage.

-With assistance, slide the QuickAir pin box into the camper/trailer's pin box brackets.

-Once lined up in the correct adjustment holes of the brackets, use the previous pin box's hardware to install the new QuickAir pin box.

NOTES: Please see SHOCKER HITCH SAFETY CHAIN INSTALLATION* below for safety chain installation as most states require it for gooseneck hitches. Some applications may require spacers for the QuickAir pin box to fit properly. Torque to 120 FT pounds.

-IMPORTANT: DO NOT overtighten the pin box bolts as this can lead to premature wear and possible failure in the pin box.

-IMPORTANT: Before sliding the QuickAir pin box in place, is recommended to use spray grease/lubricant on the pin box brackets to assist with installation and eliminate binding and/or friction.

SHOCKER HITCH SAFETY CHAIN INSTALLATION*

-Shocker Hitch sells a safety chain kit to be bolted up to your QuickAir pin box, it is crucial to use safety chains with any gooseneck hitch as most states require it by law. You may use your own safety chain kit. If you have our kit, see instructions below for proper installation.

-Using existing pin box hardware, install safety chain brackets to the 5th wheel pin box OR the Shocker Hitch QuickAir 5th to Gooseneck conversion pin box. Tighten pin box bolts to the correct torque specifications (see Figure 1). NOTE: Some pin boxes may differ in torque specifications.

-Take the 42" safety chains and feed them through the "t" shaped slot on the brackets to desired length. Once the safety chains are set to desired length, take the carriage bolts provided with the kit and tighten them on the top side of the "t" shaped slot on the brackets (see Figure 2, 3, 4, & 5).

-Complete installation by hooking up the safety chain hooks to your gooseneck chain brackets on your tow vehicle, see GOOSENECK SURGE INSTALLATION** if you still need to install your Gooseneck Surge hitch.

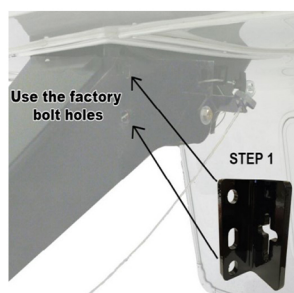

Figure 1:
Use factory bolt holes and hardware



Figure 2, 3, 4, & 5:
Slide chain through bracket to desired length and use carriage bolt to hold in place

GOOSENECK SURGE HITCH INSTALLATION**

- The Gooseneck Surge that comes with this kit is shorter than the regular gooseneck models and is only designed for the QuickAir pin box.
- Before installing the Gooseneck Surge hitch, on level ground, take a measurement from the floor on your truck bed to the ground, make note of the measurement for future reference. NOTE: You may have to accommodate for any bed rails or other accessories you may have.
- Once you have your measurement, with assistance, install your Gooseneck Surge hitch into the QuickAir pin box and set it to the noted measurement.
- Align Gooseneck Surge hitch, install hitch pin, and tighten set bolt. NOTE: Some adjustments may be required after hookup.
- Before hooking up to your towing vehicle, be sure to lubricate the coupler shifting forks and grease the coupling ball socket.
- For proper coupler usage, please refer to "HOW TO USE SHIFT LOCK COUPLER" section of the instructions.***
- IMPORTANT:** ALWAYS use safety chains with any gooseneck hitch as it is required by law in most states.

HOW TO USE SHIFT LOCK COUPLER***

- To connect to gooseneck ball, move the Shift Lock coupler handle to the unlocked position (see Figure 6).
- Lower trailer onto ball and move the Shift Lock coupler handle to the locked position and insert the quick clip pin or approved latch lock (see Figure 7).
- Look at the back of the coupler to confirm that it is locked around the ball. You will see the U-bolt sticking out of the rear of the coupler approximately 1/2". If you do not see this, the coupler is NOT locked around the ball, repeat the first two steps until you can see the U-bolt 1/2" out of the back of the coupler (see Figure 8).



Figure 6:
Shift Lock coupler in unlocked position



Figure 7:
Shift Lock coupler lowered on gooseneck ball

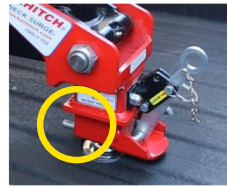

Figure 8:
Shift Lock coupler in locked position correctly

SETTING AIR

- Initially set air pressure to around 15 PSI. Test drive and adjust air pressure in 5 PSI increments until optimum results are found. Decreasing/increasing air pressure may be used. When towing in high winds, it may be necessary to increase the airbag air pressure.

-**IMPORTANT:** Never exceed 100 PSI in the airbag, this may lead to damage to the airbag.

USAGE/MAINTENANCE

- It is highly recommended that the hitch ball be greased to reduce wear.
- The Shocker Hitch should be greased regularly at the zerk located on the main pivot bolt.

SAFETY NOTICE

The Shocker Hitch is a heavy duty unit, however it is imperative that any weight capacity ratings are not exceeded on the ball that is mounted on your tow vehicle, or the Shocker Hitch. Use only a 2 5/16" dia. Ball for 2-5/16" coupler. Always use safety chains with any gooseneck hitch. Do NOT exceed Gross Vehicle Weight Rating, Gooseneck Ball Rating or Shocker Gooseneck Hitch weight ratings. The QuickAir pin box is ONLY rated for 24,000 LBS. Use only a 2-5/16" ball. DO NOT exceed the G.V.W.R. of the ball being used. Any modification to the hitch or coupler voids warranty and is done so at your own risk. Manufactured by Shocker Hitch® USA in Arthur, ND

QR CODES



HOW TO SET AIR PRESSURE



WARRANTY REGISTRATION



INSTALLATION GUIDES

THANK YOU FOR CHOOSING SHOCKER HITCH

Shocker Hitch: Safer Smoother Towing - 2801 3RD AVE SW, JAMESTOWN ND, 58401 - (701)-707-2666
-Email: service@shockerhitch.com -Website: www.shockerhitch.com -Installation Videos on [Shocker Hitch](#) YouTube Channel